



## Installation Instructions >> Crash Bars >> Suzuki DL 650

See attached pages for product kit,  
recommended tools  
and recommended torque specs.



1.

## Installation Instructions >> Crash Bars >> Suzuki DL 650

3. Next set a 17mm socket in place on the engine mount nut (left side, rider's side). You will turn this side while holding the right side. Remove the through-bolt.



4. Put on the left side (rider's left) crash bar. Using a 6mm Allen, insert the two M8 fasteners into the top mount flange. Keep the fasteners slightly loose. Don't forget to apply threadlocker!



3.

# COLTERRACIA MOTORCYCLE

---

1. Using a 4mm Allen key remove the fasteners on both sides of the bike. Now the plastic cover is only held by rubber grommets. Gently remove the cover by using both hands.  
Only DL 650 2004-2011 models. Skip this step from 2012-2016 DL 650 and XT models.



2. Use a 6mm Allen key to remove the top casting bolts on the left side where indicated.



2.

# COLTERRACIA MOTORCYCLE

---

5. Mount the right side crash bar and insert the M12x335mm through-bolt. Thread in both M8 screws into the top mount flange. Don't forget to use threadlocker and do not completely tighten the screws yet.



6. Place connector tube between the crash bars. Fasten both sides using four 6x16mm Allen head bolts, washers and nyloc nuts. Use 4mm Allen key and 10mm wrench. Do not fully tighten it, yet.



4.

# Installation Instructions >> Crash Bars >> Suzuki DL 650

7. Replace the trough-bolt nut and tighten the bolt nut down to the recommended torque specs.

8. Replace the plastic cover pieces on both sides and reinsert the OEM fasteners. Do not over-tighten!



5.

## PRODUCT KIT AND RECOMMENDED TOOLS

- 1) TORQUE WRENCH
- 2) 3/8" RATCHET
- 3) RATCHET EXTENSION
- 4) 17MM DEEP SOCKET
- 5) 17MM SOCKET
- 6) 10MM WRENCH
- 7) 6MM ALLEN KEY
- 8) 4MM ALLEN KEY
- 9) THREAD LOCKER

- 10) 4X M8X40MM ALLEN BOLTS
- 11) 4X M6X16MM ALLEN BOLTS  
+WASHERS+NYLOC NUTS
- 12) CONNECTOR PIECE
- 13) ADDITIONAL HARDWARE FOR  
"LANGAR" SKID PLATE

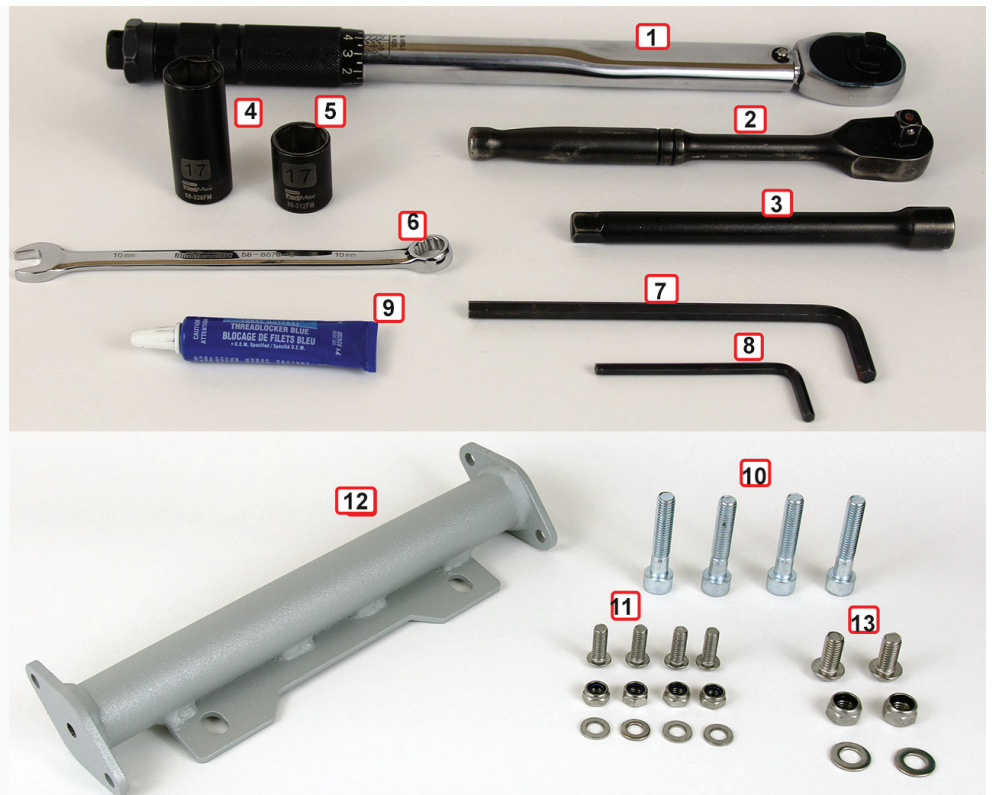

7.

11. Torque the trough-bolt nut down to the recommended specs. Check and make sure all your fasteners are tightened to the recommended torque

**Congratulations! You've completed installing your Outback Motortek product.**



Should you have any question regarding the installation, please contact us at [info@outbackmotortek.com](mailto:info@outbackmotortek.com).

Or give us a call at 1 877 931 3636

**Important note!** Outback Motortek recommends its customer to install their products by a certified, experienced motorcycle mechanic. Outback Motortek assumes no liability for any accident, injury, death, loss, or other claim related to or resulting from the use of its products. In no event shall Outback Motortek be liable for incidental or consequential damages relating to or resulting from the use of its product or any of its parts.

6.

**Table a. General bolt tightening torques in Nm (max. permissible)**

Bolt diameter	Bolt Class (according to DIN 267)					
	5.6	5.8	6.8	8.8	10.9	12.9
M5	2.5	3.5	4.5	6	8	10
M6	4.5	6	7.5 <small>5.5 ft lb</small>	10 <small>7.4 ft lb</small>	14 <small>10.3 ft lb</small>	17
M8	11	15 <small>11.1 ft lb</small>	18 <small>13.3 ft lb</small>	24 <small>17.7 ft lb</small>	34 <small>25.1 ft lb</small>	40
M10	23	30 <small>22.1 ft lb</small>	36 <small>26.6 ft lb</small>	47 <small>34.6 ft lb</small>	66 <small>48.7 ft lb</small>	79
M12	39	52 <small>38.4 ft lb</small>	62 <small>45.7 ft lb</small>	82 <small>60.5 ft lb</small>	115	140
M14	62	82	98	130	180	220
M16	94	126	150	200	280	340
M18	130	174	210	280	390	470

8.